

## 900-200 Instrument Lite Relampable Indicator Lights

### Description and Features

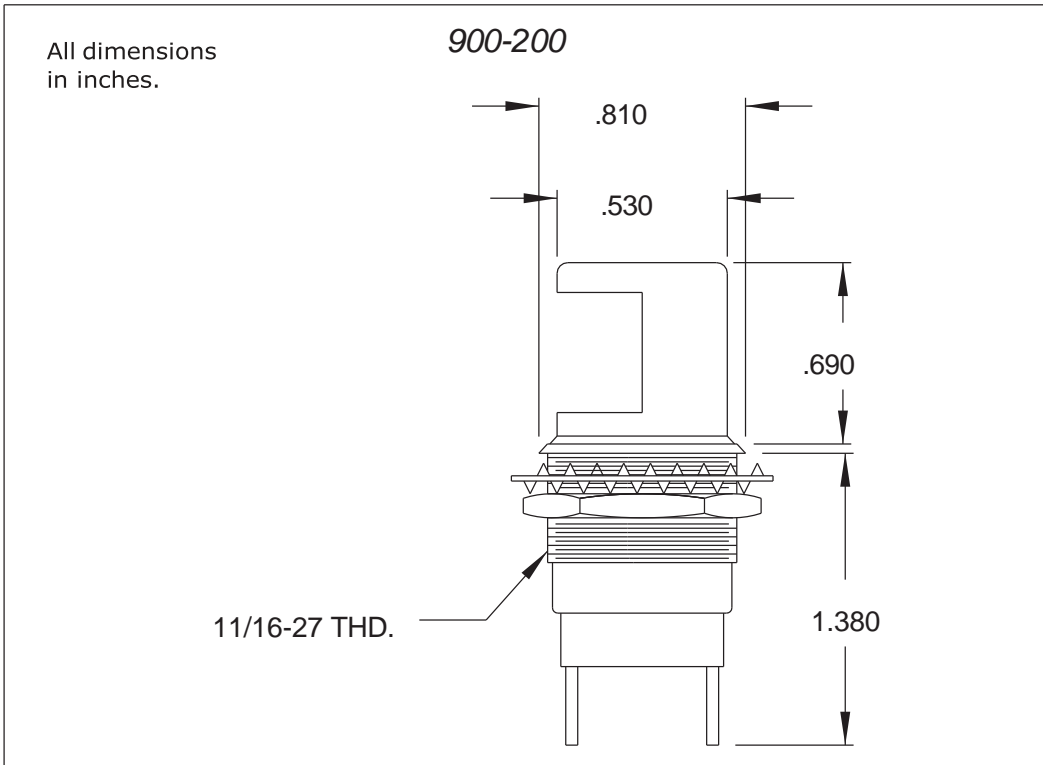

900-200 Lamp Instrument Lites are specifically designed to provide localized light for illuminating panels, meters, switches and legends. The Lamp Instrument Lite features a highly reflective surface on the inside of the hood to assure peak light output and is easily re-lamped from the front of the panel. The lamp is not included with this indicator light; order the required lamp separately.

## Specifications

	900-200
Mounting Hole:	.688
Mounting Centers:	.969
Maximum Panel Thickness:	.406
Housing/Material:	Black anodized aluminum
Hood Material:	Black matte on aluminum
Terminals:	Solder lug terminals
Hex Nut:	Zinc Plated steel
Lock washer:	Chrome treated steel
Electrical Rating:	up to 250 Volts, up to 3 Watts
Lamp Used:	T-2 or T-3 1/4 Miniature bayonet